

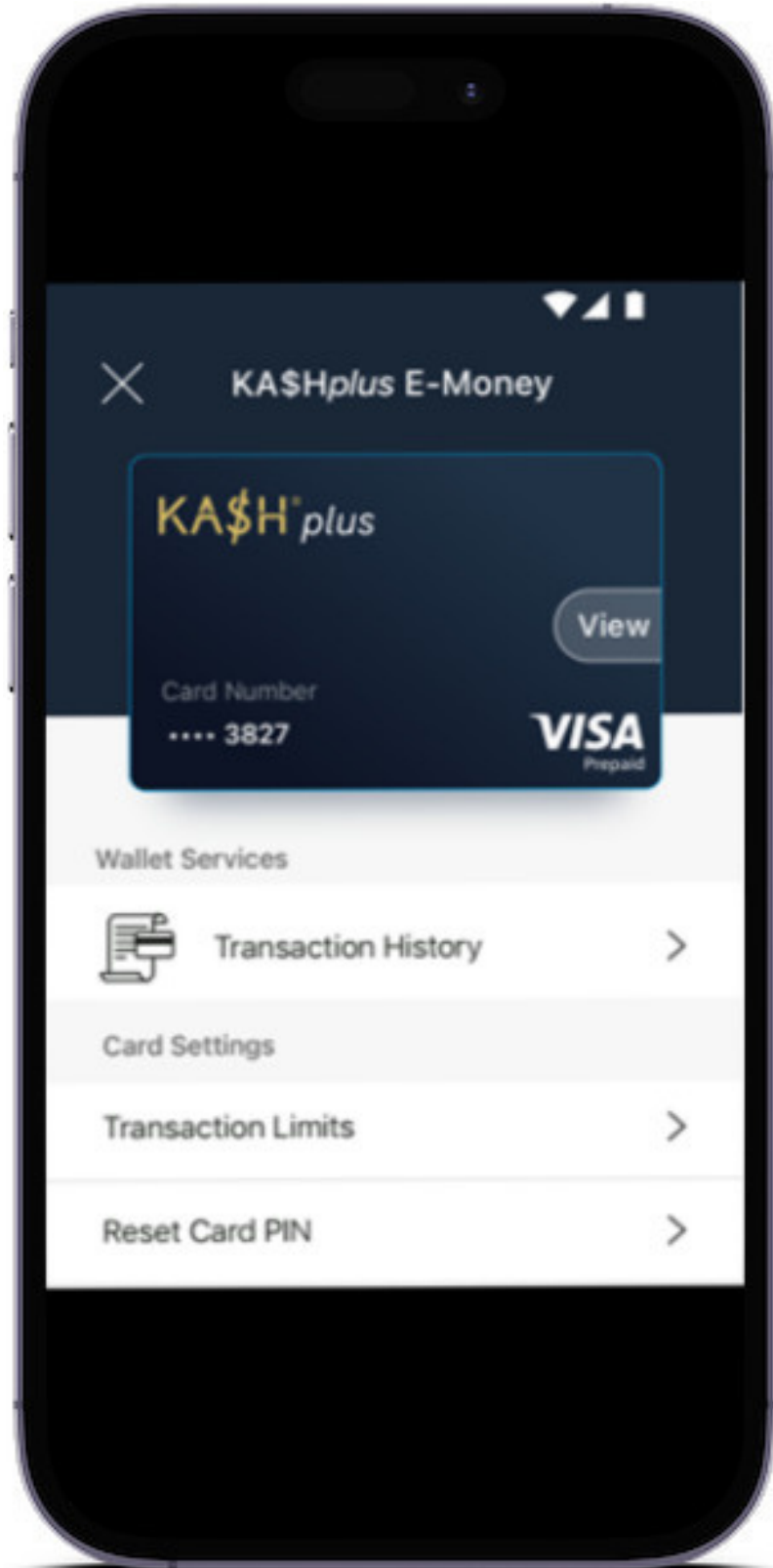

Reset Card PIN

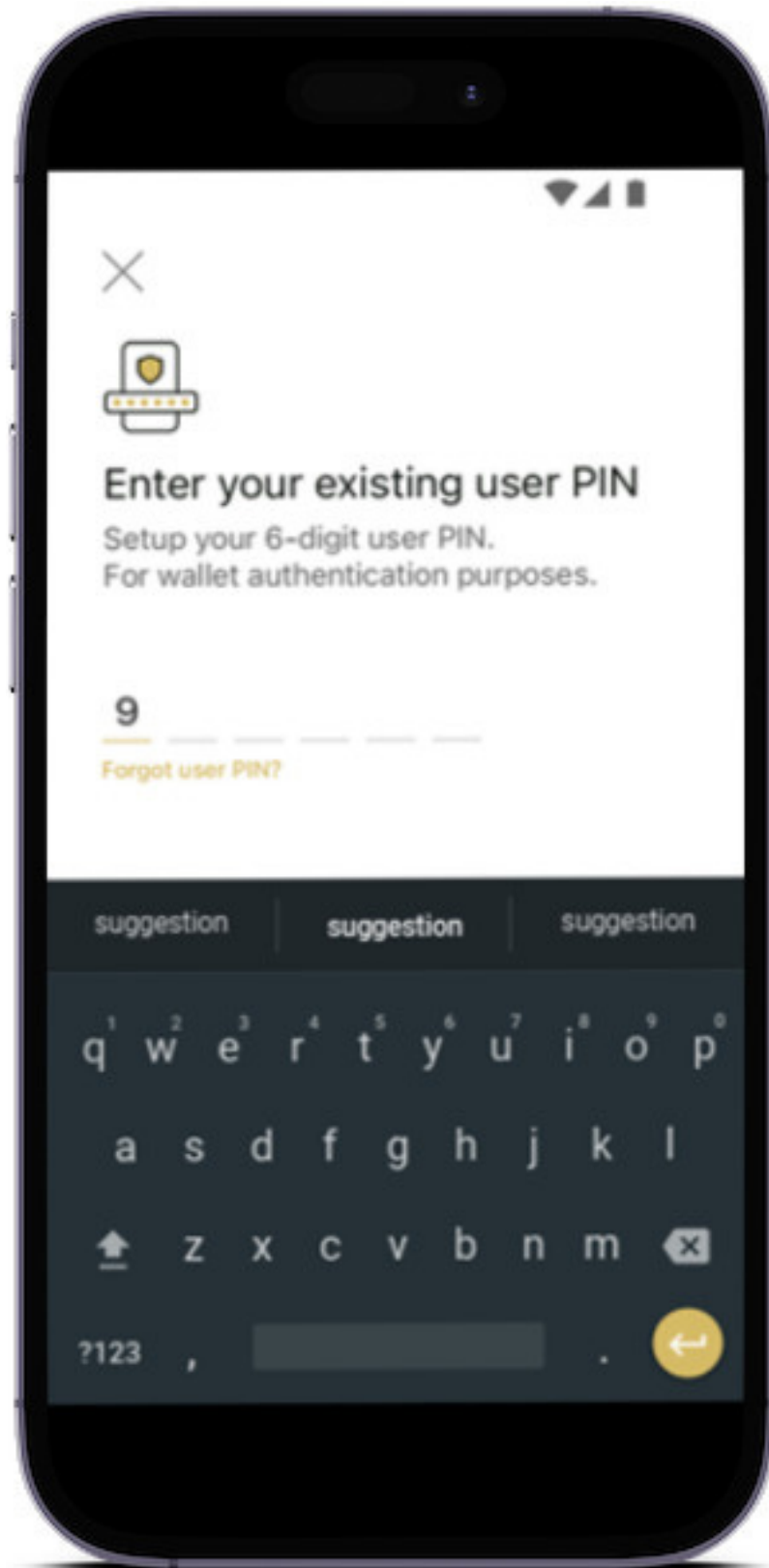

1. Select 'Reset Card PIN'.



2. Enter your user PIN.



3. Enter the OTP code.

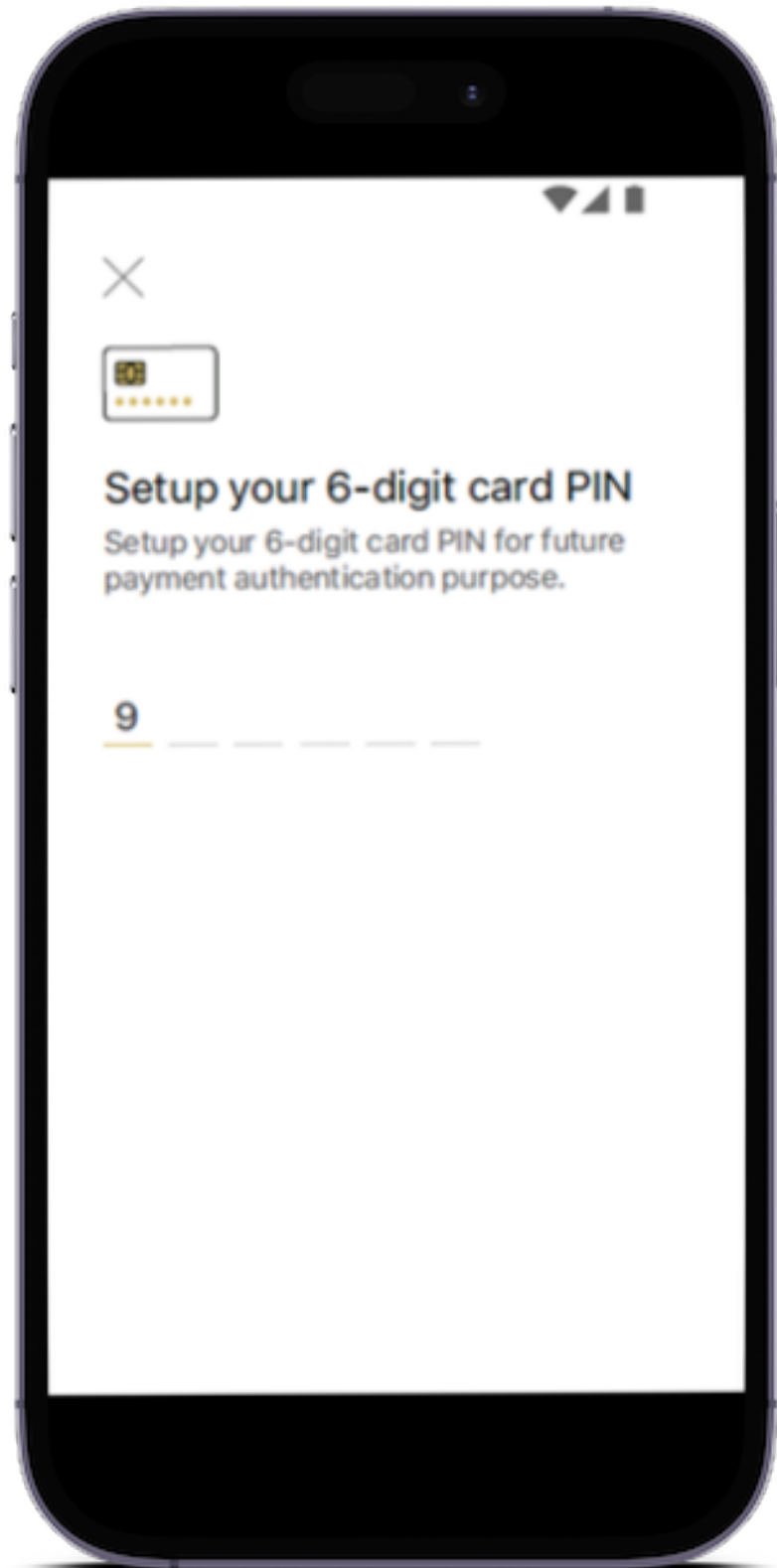

4. Create a new PIN.

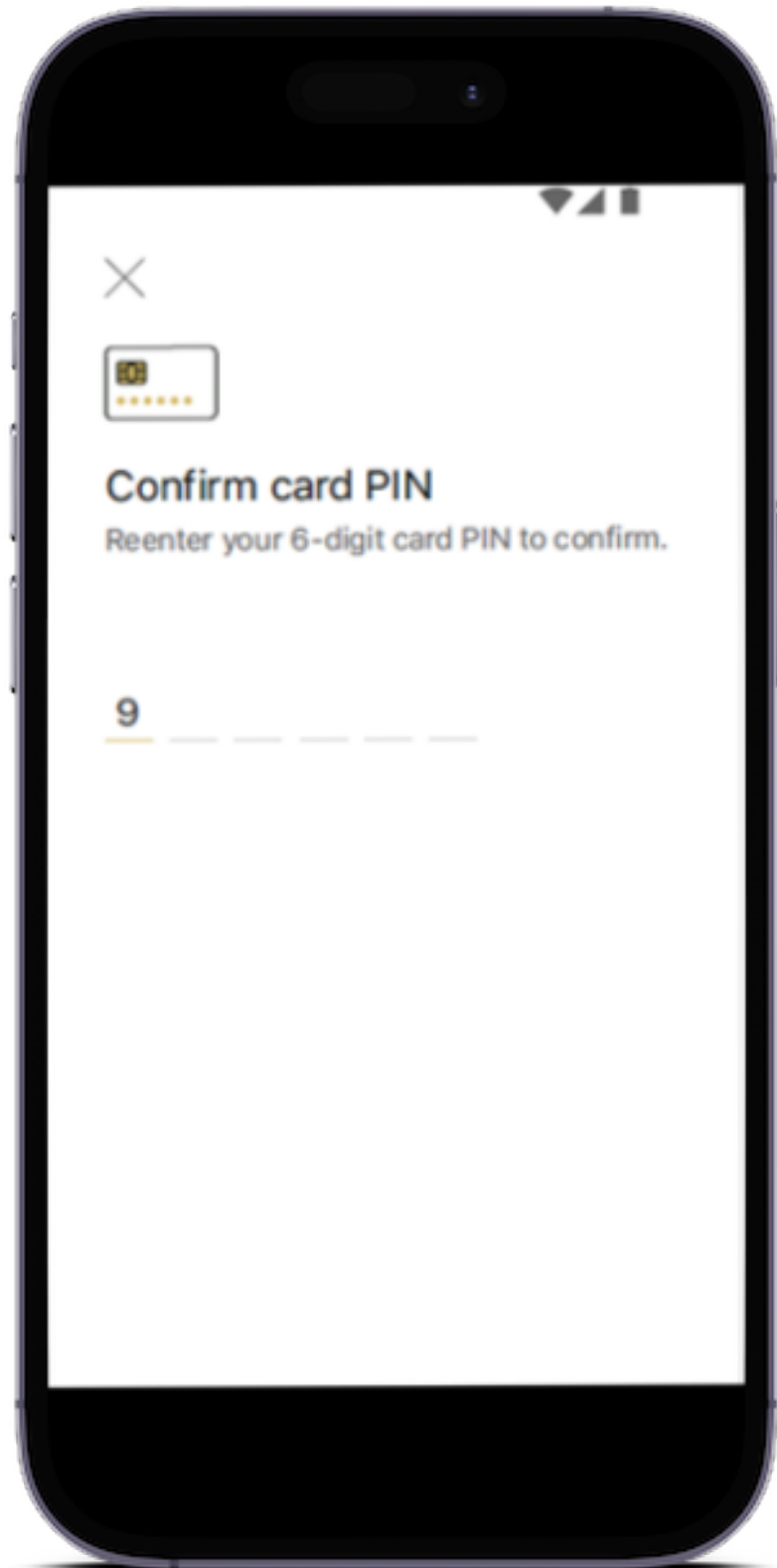

5. Confirm the new PIN.

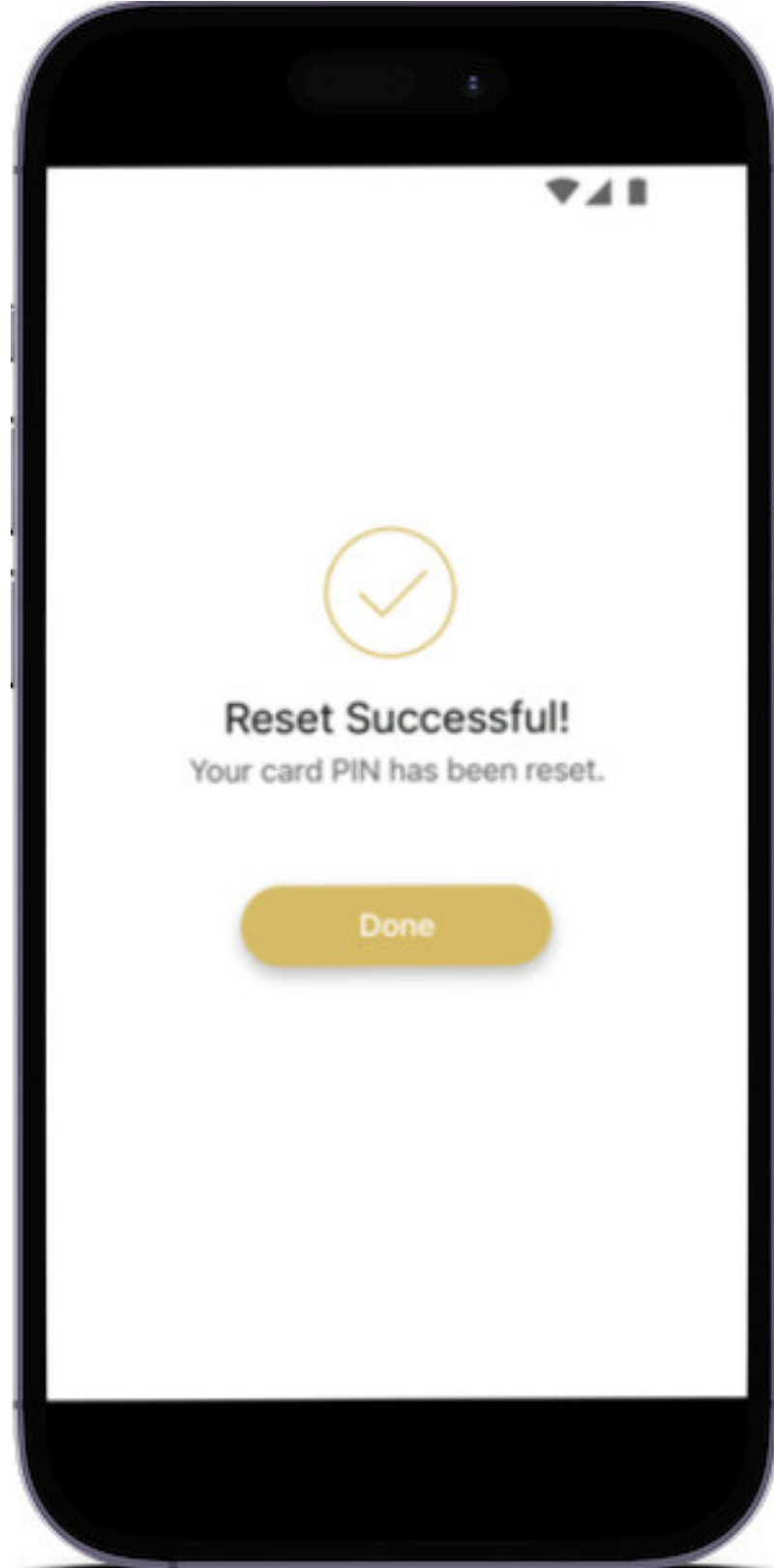

6. Card PIN reset is successful!

For enquiry/assistance:

Email: pluscare@kash.my

<https://kashplusmalaysia.wasap.my>

<https://wa.me/60192602181>