

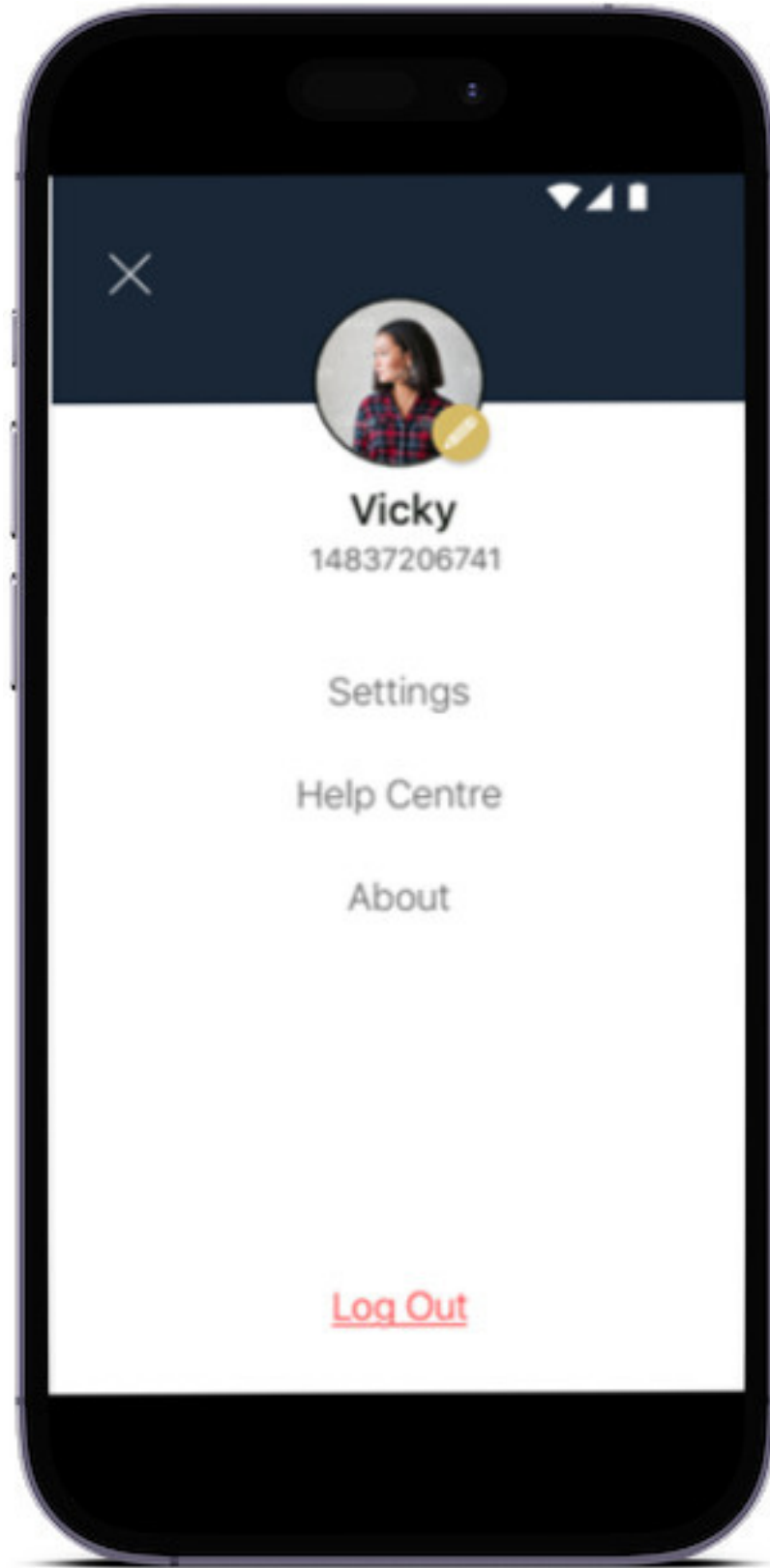

# Changing User PIN



1. Select the icon as highlighted.



2. Select 'Settings'.



3. Select 'Change User PIN'.

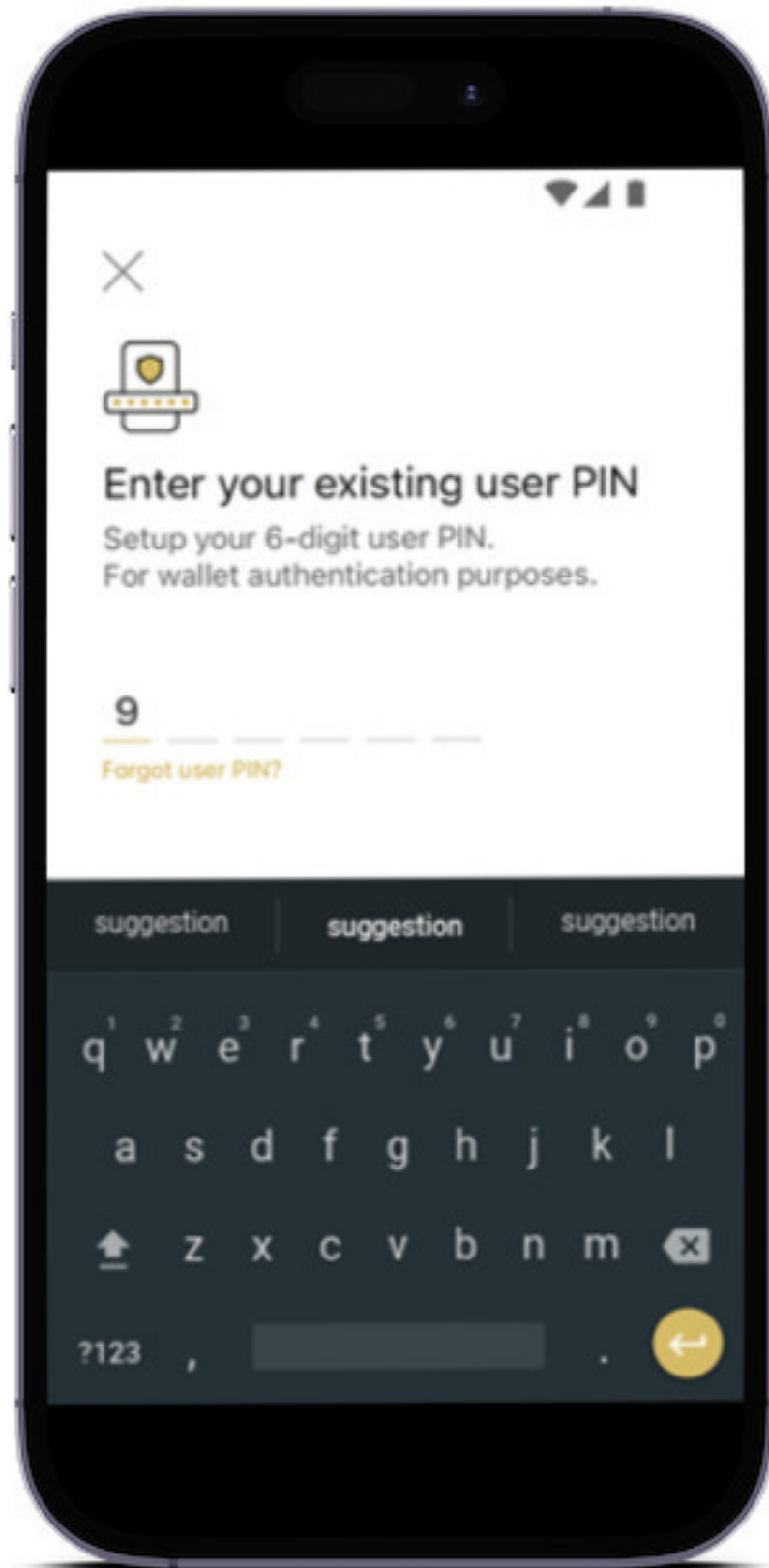

4. Enter the existing User PIN.

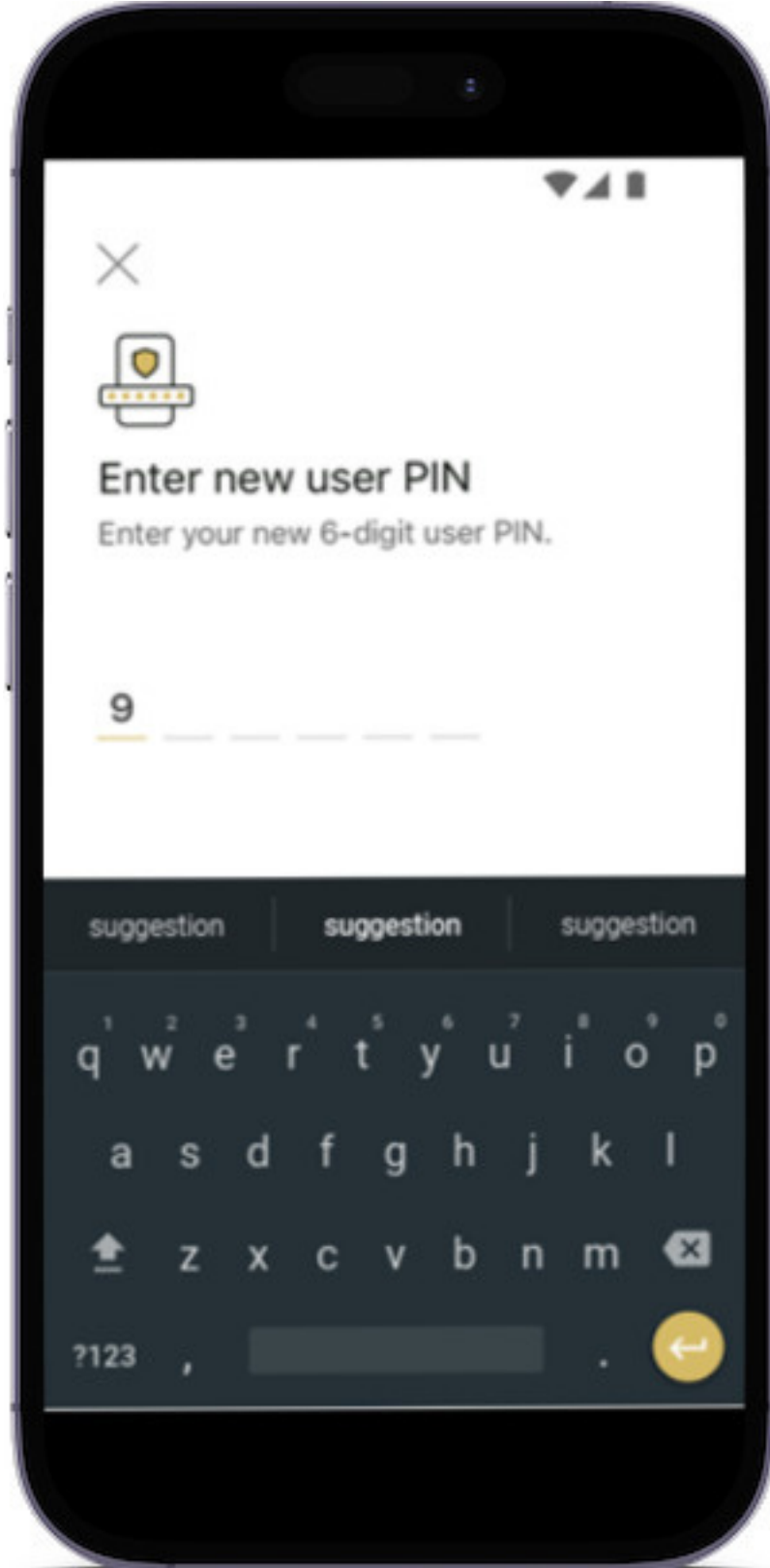

5. Create a new User PIN.

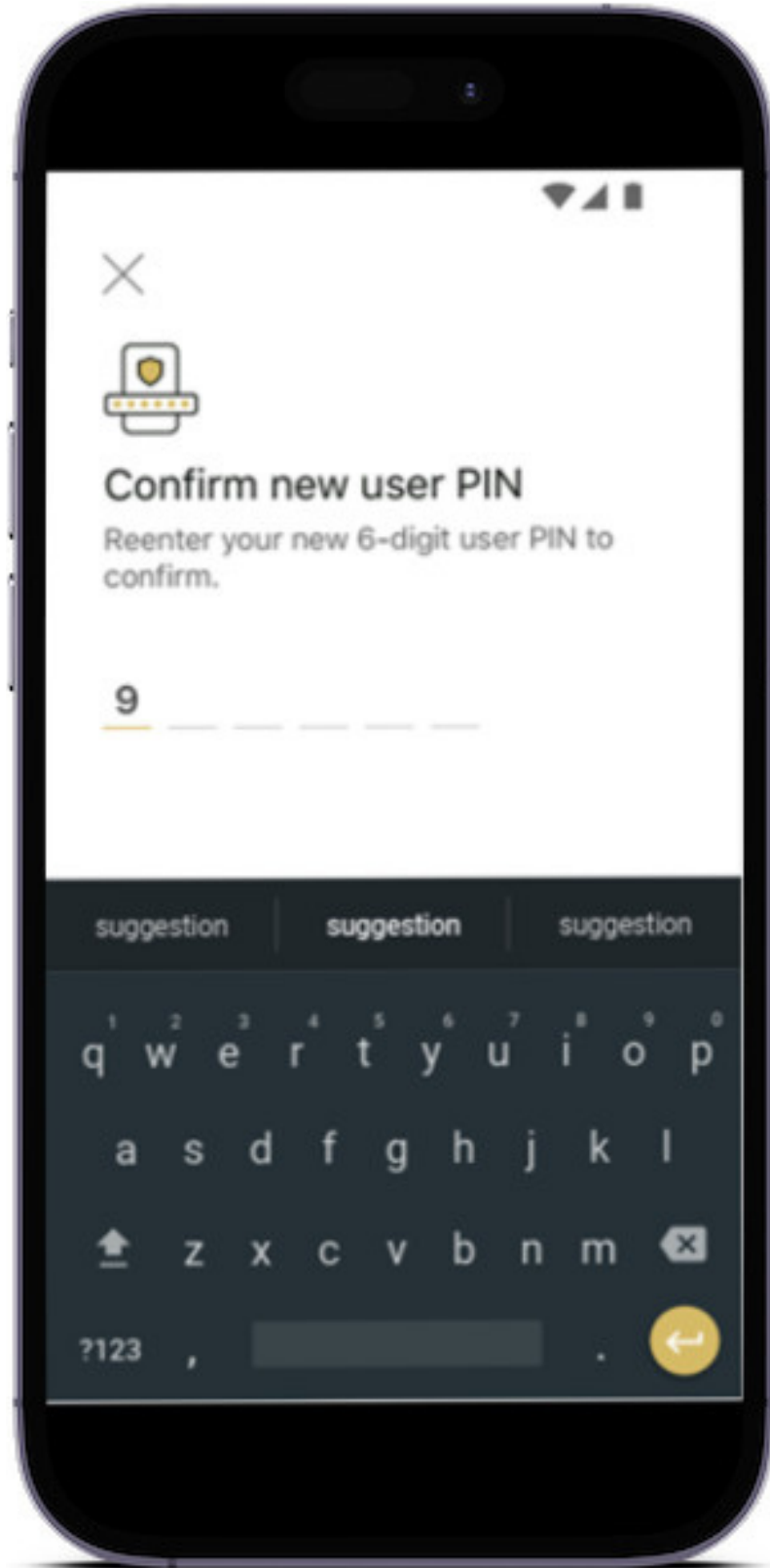

6. Confirm the new User PIN.

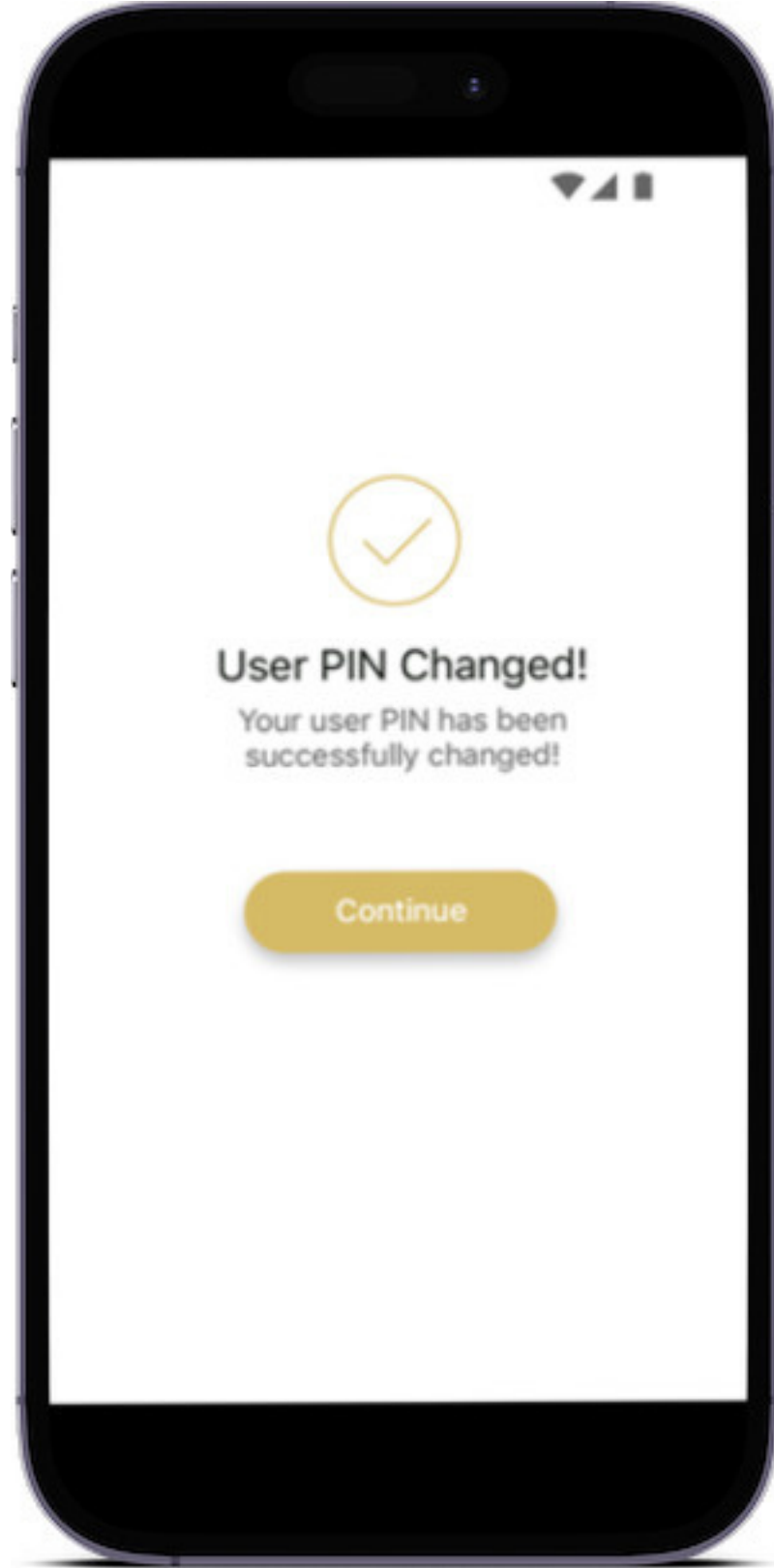

**7. Your User PIN has been successfully changed!**



**For enquiry/assistance:**

Email: [pluscare@kash.my](mailto:pluscare@kash.my)

<https://kashplusmalaysia.wasap.my>

<https://wa.me/60192602181>